

Definition: all metal single slotted self-locking riveting nut

Threading: standard to ISO 965-2

Characteristic and performance test: for steel ISO 898-2 / ISO 2320
for stainless steel ISO 3506-2 / NF E 25035

d	s	Jo + 0,05	B	C	sheet thickness	ø Boring
M 4	8,00	6,74	5,30	1,60	1,50	6,55
				2,20	2,00	à
				2,60	2,50	6,65
M 6	11,00	8,90	7,00	2,20	2,00	8,70
				2,60	2,50	à
				3,40	3,00	8,80
M 8	14,00	10,50	9,80	2,60	2,50	10,30
				3,40	3,00	à
				4,20	4,00	10,40

Sizes: The sheet thicknesses were given as examples, please contact us for other thicknesses

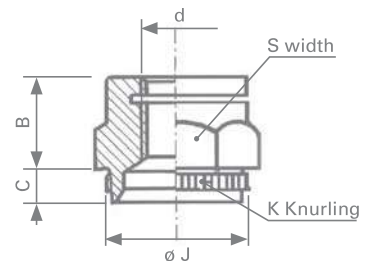

Assembly instruction

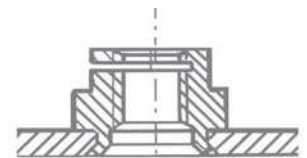

ESF riveting nut

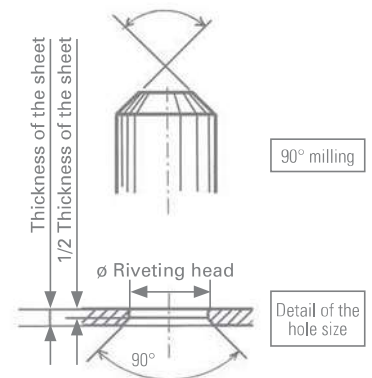

Quality class	Classification	Range of application
Class 8 steel / Grade 5	QV	Self color -50° C +300° C ⁽¹⁾
Stainless steel A4-80	ZH	Corrosive atmosphere -200° C +400° C ⁽¹⁾

⁽¹⁾ Values are only given as an indication

Surface treatment (standard to ROHS requirements)			
Electroplated Zinc (steel)	Yellow	ZJ	ISO 4042
	Clear Lanthane ®	ZL	400 h
	Clear Lanthane ® + Topcoat	ZF	600 h
Zinc Flake (steel)	Geomet ®, Delta Protekt ®, Magni ®		600 / 1000h
Antigalling (stainless steel)	Stanal ® 400	ST	
	Sherardisation (NF EN 13811)	SH	
Plain Finish	Light Protective Oil	BT	

Example of ordering code

	Type	Diam X pitch	Class	Protection	
classification	ESF	060100	QV	ZL	26
wording	ESF	M6 X 1,00	8	Zinc Lanthane®	2,6*

* Sheet thickness

On request: other materials, plating, sizes, imperial thread